

## Spring plungers smooth version, extended, stainless steel

### Item description/product images



### Description

#### Material:

Sleeve and spring stainless steel.

Ball stainless steel or POM.

#### Version:

Sleeve bright.

Steel ball hardened and bright.

### Drawings

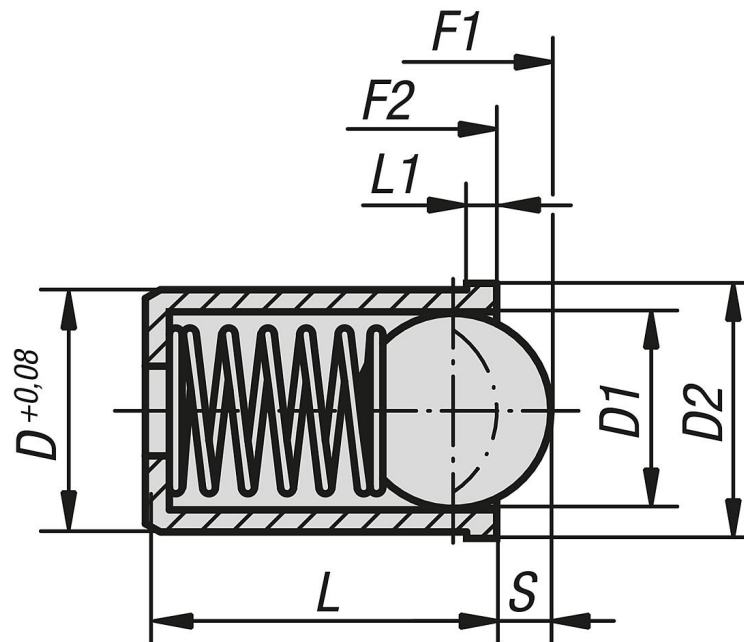

### Overview of items

#### Spring plungers smooth version, extended, stainless steel

Order No.	Component material	D	D1	D2	L	L1	Travel S	Spring force initial pressure F1 approx. N	Spring force final pressure F2 approx. N
B0035.104	stainless steel	4	3	4,6	9	1	0,8	12	22
B0035.105	stainless steel	5	4	5,6	12	1	1	19	30
B0035.106	stainless steel	6	5	6,5	14	1	1,5	22	40
B0035.108	stainless steel	8	6	8,5	16	1	1,8	42	73
B0035.110	stainless steel	10	8	12	22	2,5	2,7	54	100
B0035.112	stainless steel	12	10	14	24	2,5	3,5	54	122
B0035.404	POM	4	3	4,6	9	1	0,6	12	22
B0035.405	POM	5	4	5,6	12	1	0,8	19	30

## Spring plungers smooth version, extended, stainless steel

### Overview of items

Order No.	Component material	D	D1	D2	L	L1	Travel S	Spring force initial pressure F1 approx. N	Spring force final pressure F2 approx. N
<b>B0035.406</b>	POM	6	5	6,5	14	1	1,3	22	40
<b>B0035.408</b>	POM	8	6	8,5	16	1	1,6	42	73
<b>B0035.410</b>	POM	10	8	12	22	2,5	2,6	54	100
<b>B0035.412</b>	POM	12	10	14	24	2,5	3,3	54	122