

# Grippers and inserts round, with counterbore

## Item description/product images



### Description

**Material:**

Form C, F tool steel  
 Form E, O stainless steel  
 Form K POM

**Version:**

Form C, F hardened and black oxidised.  
 Form E, hardened, bright.  
 Form K white.  
 Form O with diamond impregnated surface comparable to 100 grade abrasive grit.

## Drawings

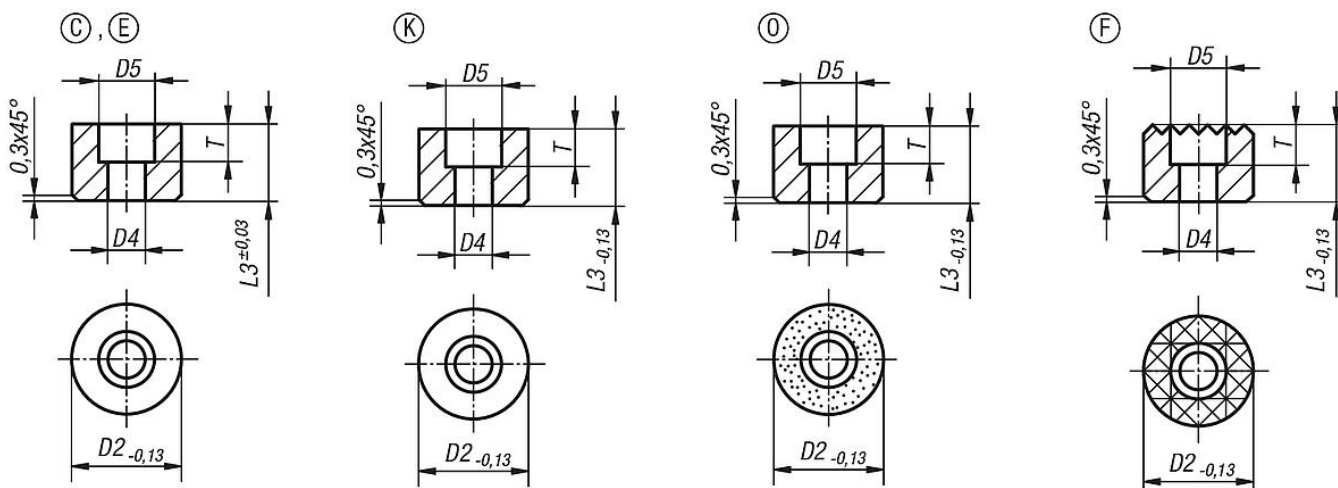

## Overview of items

### Round inserts

Order No. Form C	Order No. Form O	Order No. Form K	Order No. Form E	D2	D4	D5	L3	T
B0168.110108	B0168.110105	B0168.110109	B0168.110102	10	3,4	6	10	5
B0168.110128	B0168.110125	B0168.110129	B0168.110122	10	3,4	6	12	5
-	B0168.112105	-	-	12	4,5	8	10	5,6
-	B0168.112125	-	-	12	4,5	8	12	5,6
B0168.112108	-	B0168.112109	B0168.112102	12	4,5	9	10	5,6
B0168.112128	-	B0168.112129	B0168.112122	12	4,5	9	12	5,6
B0168.116108	B0168.116105	B0168.116109	B0168.116102	16	5,5	11	10	6,6
B0168.116128	B0168.116125	B0168.116129	B0168.116122	16	5,5	11	12	6,6
B0168.120108	B0168.120105	B0168.120109	B0168.120102	20	6,6	11	10	7,6
B0168.120128	B0168.120125	B0168.120129	B0168.120122	20	6,6	11	12	7,6
B0168.125108	B0168.125105	B0168.125109	B0168.125102	25	6,6	11	10	7,6
B0168.125128	B0168.125125	B0168.125129	B0168.125122	25	6,6	11	12	7,6

### Round grippers

Order No. Form F	D2	D4	D5	L3	T
B0168.11210	12	4,5	8	10	5,6
B0168.11212	12	4,5	8	12	5,6

## Grippers and inserts round, with counterbore

### Overview of items

Order No. Form F	D2	D4	D5	L3	T
<b>B0168.11610</b>	16	4,5	8	10	5,6
<b>B0168.11612</b>	16	4,5	8	12	5,6
<b>B0168.12010</b>	20	5,5	10	10	6,6
<b>B0168.12012</b>	20	5,5	10	12	6,6
<b>B0168.12510</b>	25	6,6	11	10	7,6
<b>B0168.12512</b>	25	6,6	11	12	7,6