

Hexagon nuts DIN 934

Item description/product images

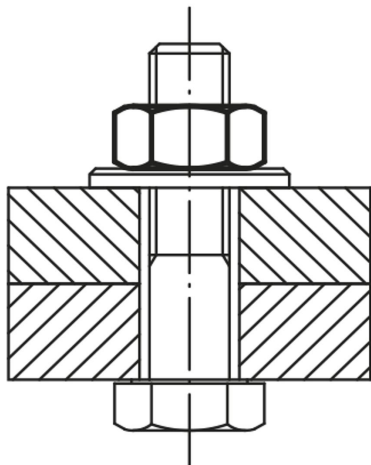

Description

Material:

Steel, stainless steel A2 or stainless steel A4.

Version:

Steel grade 8, bright or electro zinc-plated.

Steel grade 10, bright or electro zinc-plated.

Steel grade 12, bright.

Stainless steel A2-70, bright.

Stainless steel A4-70, bright.

Note:

The grade of a nut must always be the same or higher than the grade of a bolt. That is, bolts in grade 8.8 are always paired with a nut in grade 8 (or higher, but never lower).

The maximum nut height H max. is shown in the table.

On request:

DIN ISO 272 spanner sizes.

Drawings

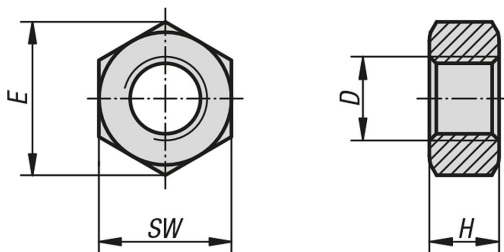

Overview of items

Order No.	Material	Grade	Surface finish body	D	E	H	SW
B0101.025	steel	8	bright (black)	M2,5	5,45	2	5
B0101.03	steel	8	bright (black)	M3	6,01	2,4	5,5
B0101.04	steel	8	bright (black)	M4	7,66	3,2	7
B0101.05	steel	8	bright (black)	M5	8,79	4	8
B0101.06	steel	8	bright (black)	M6	11,05	5	10
B0101.08	steel	8	bright (black)	M8	14,38	6,5	13
B0101.10	steel	8	bright (black)	M10	18,9	8	17
B0101.12	steel	8	bright (black)	M12	21,1	10	19
B0101.14	steel	8	bright (black)	M14	23,9	11	22
B0101.16	steel	8	bright (black)	M16	26,76	13	24
B0101.20	steel	8	bright (black)	M20	32,95	16	30
B0101.22	steel	8	bright (black)	M22	35	18	32
B0101.24	steel	8	bright (black)	M24	39,6	19	36
B0101.27	steel	8	bright (black)	M27	45,2	22	41
B0101.30	steel	8	bright (black)	M30	50,9	24	46
B0101.33	steel	8	bright (black)	M33	55,4	26	50

Hexagon nuts DIN 934

Overview of items

Order No.	Material	Grade	Surface finish body	D	E	H	SW
B0101.36	steel	8	bright (black)	M36	60,8	29	55
B0101.2025	steel	8	galvanised	M2,5	5,45	2	5
B0101.203	steel	8	galvanised	M3	6,01	2,4	5,5
B0101.204	steel	8	galvanised	M4	7,66	3,2	7
B0101.205	steel	8	galvanised	M5	8,79	4	8
B0101.206	steel	8	galvanised	M6	11,05	5	10
B0101.208	steel	8	galvanised	M8	14,38	6,5	13
B0101.210	steel	8	galvanised	M10	18,9	8	17
B0101.212	steel	8	galvanised	M12	21,1	10	19
B0101.214	steel	8	galvanised	M14	23,9	11	22
B0101.216	steel	8	galvanised	M16	26,76	13	24
B0101.220	steel	8	galvanised	M20	32,95	16	30
B0101.222	steel	8	galvanised	M22	35	18	32
B0101.224	steel	8	galvanised	M24	39,6	19	36
B0101.227	steel	8	galvanised	M27	45,2	22	41
B0101.230	steel	8	galvanised	M30	50,9	24	46
B0101.233	steel	8	galvanised	M33	55,4	26	50
B0101.236	steel	8	galvanised	M36	60,8	29	55
B0101.403	steel	10	bright (black)	M3	6,01	2,4	5,5
B0101.404	steel	10	bright (black)	M4	7,66	3,2	7
B0101.405	steel	10	bright (black)	M5	8,79	4	8
B0101.406	steel	10	bright (black)	M6	11,05	5	10
B0101.408	steel	10	bright (black)	M8	14,38	6,5	13
B0101.410	steel	10	bright (black)	M10	18,9	8	17
B0101.412	steel	10	bright (black)	M12	21,1	10	19
B0101.414	steel	10	bright (black)	M14	23,9	11	22
B0101.416	steel	10	bright (black)	M16	26,76	13	24
B0101.420	steel	10	bright (black)	M20	32,95	16	30
B0101.422	steel	10	bright (black)	M22	35	18	32
B0101.424	steel	10	bright (black)	M24	39,6	19	36
B0101.427	steel	10	bright (black)	M27	45,2	22	41
B0101.430	steel	10	bright (black)	M30	50,9	24	46
B0101.433	steel	10	bright (black)	M33	55,4	26	50
B0101.436	steel	10	bright (black)	M36	60,8	29	55
B0101.304	steel	10	galvanised	M4	7,66	3,2	7
B0101.305	steel	10	galvanised	M5	8,79	4	8
B0101.306	steel	10	galvanised	M6	11,05	5	10
B0101.308	steel	10	galvanised	M8	14,38	6,5	13
B0101.310	steel	10	galvanised	M10	18,9	8	17
B0101.312	steel	10	galvanised	M12	21,1	10	19
B0101.314	steel	10	galvanised	M14	23,9	11	22
B0101.316	steel	10	galvanised	M16	26,76	13	24
B0101.320	steel	10	galvanised	M20	32,95	16	30
B0101.322	steel	10	galvanised	M22	35	18	32
B0101.324	steel	10	galvanised	M24	39,6	19	36
B0101.327	steel	10	galvanised	M27	45,2	22	41
B0101.330	steel	10	galvanised	M30	50,9	24	46
B0101.333	steel	10	galvanised	M33	55,4	26	50
B0101.336	steel	10	galvanised	M36	60,8	29	55
B0101.506	steel	12	bright (black)	M6	11,05	5	10
B0101.508	steel	12	bright (black)	M8	14,38	6,5	13
B0101.510	steel	12	bright (black)	M10	18,9	8	17
B0101.512	steel	12	bright (black)	M12	21,1	10	19
B0101.516	steel	12	bright (black)	M16	26,76	13	24
B0101.520	steel	12	bright (black)	M20	32,95	16	30
B0101.524	steel	12	bright (black)	M24	39,6	19	36
B0101.527	steel	12	bright (black)	M27	45,2	22	41
B0101.530	steel	12	bright (black)	M30	50,9	24	46
B0101.536	steel	12	bright (black)	M36	60,8	29	55
B0101.1025	stainless steel A2	70	bright	M2,5	5,45	2	5
B0101.103	stainless steel A2	70	bright	M3	6,01	2,4	5,5
B0101.104	stainless steel A2	70	bright	M4	7,66	3,2	7

Hexagon nuts DIN 934

Overview of items

Order No.	Material	Grade	Surface finish body	D	E	H	SW
B0101.105	stainless steel A2	70	bright	M5	8,79	4	8
B0101.106	stainless steel A2	70	bright	M6	11,05	5	10
B0101.108	stainless steel A2	70	bright	M8	14,38	6,5	13
B0101.110	stainless steel A2	70	bright	M10	18,9	8	17
B0101.112	stainless steel A2	70	bright	M12	21,1	10	19
B0101.116	stainless steel A2	70	bright	M16	26,76	13	24
B0101.120	stainless steel A2	70	bright	M20	32,95	16	30
B0101.130	stainless steel A2	70	bright	M30	50,9	24	46
B0101.136	stainless steel A2	70	bright	M36	60,8	29	55
B0101.114	stainless steel A2	70	bright	M14	23,9	11	22
B0101.122	stainless steel A2	70	bright	M22	35	18	32
B0101.124	stainless steel A2	70	bright	M24	39,6	19	36
B0101.127	stainless steel A2	70	bright	M27	45,2	22	41
B0101.133	stainless steel A2	70	bright	M33	55,4	26	50
B0101.5025	stainless steel A4	70	bright	M2,5	5,45	2	5
B0101.603	stainless steel A4	70	bright	M3	6,01	2,4	5,5
B0101.604	stainless steel A4	70	bright	M4	7,66	3,2	7
B0101.605	stainless steel A4	70	bright	M5	8,79	4	8
B0101.606	stainless steel A4	70	bright	M6	11,05	5	10
B0101.608	stainless steel A4	70	bright	M8	14,38	6,5	13
B0101.610	stainless steel A4	70	bright	M10	18,9	8	17
B0101.612	stainless steel A4	70	bright	M12	21,1	10	19
B0101.614	stainless steel A4	70	bright	M14	23,9	11	22
B0101.616	stainless steel A4	70	bright	M16	26,76	13	24
B0101.620	stainless steel A4	70	bright	M20	32,95	16	30
B0101.622	stainless steel A4	70	bright	M22	35	18	32
B0101.624	stainless steel A4	70	bright	M24	39,6	19	36
B0101.627	stainless steel A4	70	bright	M27	45,2	22	41
B0101.630	stainless steel A4	70	bright	M30	50,9	24	46
B0101.633	stainless steel A4	70	bright	M33	55,4	26	50
B0101.636	stainless steel A4	70	bright	M36	60,8	29	55