

Hexagon nuts DIN 934, steel

Item description/product images

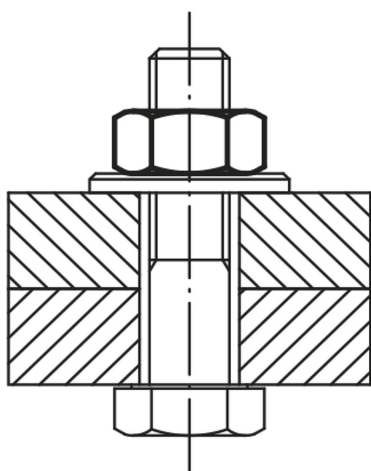

Description

Material:

Steel.

Version:

Steel grade 8, bright or electro zinc-plated.

Steel grade 10, bright or electro zinc-plated.

Steel grade 12, bright.

Note:

The grade of a nut must always be the same or higher than the grade of a bolt. That is, bolts in grade 8.8 are always paired with a nut in grade 8 (or higher, but never lower).

The maximum nut height H max. is shown in the table.

On request:

DIN ISO 272 spanner sizes.

Drawings

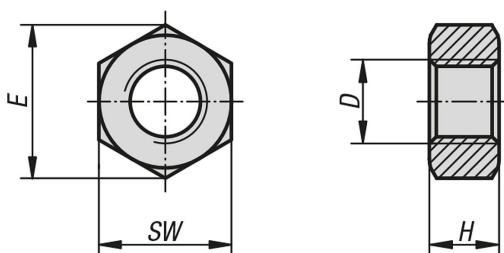

Overview of items

Order No.	Material	Surface finish body	Grade	D	E	H	SW	DIN
B0101.025	steel	bright (black)	8	M2,5	5,45	2	5	DIN 934
B0101.03	steel	bright (black)	8	M3	6,01	2,4	5,5	DIN 934
B0101.04	steel	bright (black)	8	M4	7,66	3,2	7	DIN 934
B0101.05	steel	bright (black)	8	M5	8,79	4	8	DIN 934
B0101.06	steel	bright (black)	8	M6	11,05	5	10	DIN 934
B0101.08	steel	bright (black)	8	M8	14,38	6,5	13	DIN 934
B0101.10	steel	bright (black)	8	M10	18,9	8	17	DIN 934
B0101.12	steel	bright (black)	8	M12	21,1	10	19	DIN 934
B0101.14	steel	bright (black)	8	M14	23,9	11	22	DIN 934
B0101.16	steel	bright (black)	8	M16	26,76	13	24	DIN 934

Hexagon nuts DIN 934, steel

Overview of items

Order No.	Material	Surface finish body	Grade	D	E	H	SW	DIN
B0101.20	steel	bright (black)	8	M20	32,95	16	30	DIN 934
B0101.22	steel	bright (black)	8	M22	35	18	32	DIN 934
B0101.24	steel	bright (black)	8	M24	39,6	19	36	DIN 934
B0101.27	steel	bright (black)	8	M27	45,2	22	41	DIN 934
B0101.30	steel	bright (black)	8	M30	50,9	24	46	DIN 934
B0101.33	steel	bright (black)	8	M33	55,4	26	50	DIN 934
B0101.36	steel	bright (black)	8	M36	60,8	29	55	DIN 934
B0101.2025	steel	galvanised	8	M2,5	5,45	2	5	DIN 934
B0101.203	steel	galvanised	8	M3	6,01	2,4	5,5	DIN 934
B0101.204	steel	galvanised	8	M4	7,66	3,2	7	DIN 934
B0101.205	steel	galvanised	8	M5	8,79	4	8	DIN 934
B0101.206	steel	galvanised	8	M6	11,05	5	10	DIN 934
B0101.208	steel	galvanised	8	M8	14,38	6,5	13	DIN 934
B0101.210	steel	galvanised	8	M10	18,9	8	17	DIN 934
B0101.212	steel	galvanised	8	M12	21,1	10	19	DIN 934
B0101.214	steel	galvanised	8	M14	23,9	11	22	DIN 934
B0101.216	steel	galvanised	8	M16	26,76	13	24	DIN 934
B0101.220	steel	galvanised	8	M20	32,95	16	30	DIN 934
B0101.222	steel	galvanised	8	M22	35	18	32	DIN 934
B0101.224	steel	galvanised	8	M24	39,6	19	36	DIN 934
B0101.227	steel	galvanised	8	M27	45,2	22	41	DIN 934
B0101.230	steel	galvanised	8	M30	50,9	24	46	DIN 934
B0101.233	steel	galvanised	8	M33	55,4	26	50	DIN 934
B0101.236	steel	galvanised	8	M36	60,8	29	55	DIN 934
B0101.403	steel	bright (black)	10	M3	6,01	2,4	5,5	DIN 934
B0101.404	steel	bright (black)	10	M4	7,66	3,2	7	DIN 934
B0101.405	steel	bright (black)	10	M5	8,79	4	8	DIN 934
B0101.406	steel	bright (black)	10	M6	11,05	5	10	DIN 934
B0101.408	steel	bright (black)	10	M8	14,38	6,5	13	DIN 934
B0101.410	steel	bright (black)	10	M10	18,9	8	17	DIN 934
B0101.412	steel	bright (black)	10	M12	21,1	10	19	DIN 934
B0101.414	steel	bright (black)	10	M14	23,9	11	22	DIN 934
B0101.416	steel	bright (black)	10	M16	26,76	13	24	DIN 934
B0101.420	steel	bright (black)	10	M20	32,95	16	30	DIN 934
B0101.422	steel	bright (black)	10	M22	35	18	32	DIN 934
B0101.424	steel	bright (black)	10	M24	39,6	19	36	DIN 934
B0101.427	steel	bright (black)	10	M27	45,2	22	41	DIN 934
B0101.430	steel	bright (black)	10	M30	50,9	24	46	DIN 934
B0101.433	steel	bright (black)	10	M33	55,4	26	50	DIN 934
B0101.436	steel	bright (black)	10	M36	60,8	29	55	DIN 934
B0101.304	steel	galvanised	10	M4	7,66	3,2	7	DIN 934
B0101.305	steel	galvanised	10	M5	8,79	4	8	DIN 934
B0101.306	steel	galvanised	10	M6	11,05	5	10	DIN 934
B0101.308	steel	galvanised	10	M8	14,38	6,5	13	DIN 934
B0101.310	steel	galvanised	10	M10	18,9	8	17	DIN 934
B0101.312	steel	galvanised	10	M12	21,1	10	19	DIN 934
B0101.314	steel	galvanised	10	M14	23,9	11	22	DIN 934
B0101.316	steel	galvanised	10	M16	26,76	13	24	DIN 934
B0101.320	steel	galvanised	10	M20	32,95	16	30	DIN 934
B0101.322	steel	galvanised	10	M22	35	18	32	DIN 934
B0101.324	steel	galvanised	10	M24	39,6	19	36	DIN 934
B0101.327	steel	galvanised	10	M27	45,2	22	41	DIN 934
B0101.330	steel	galvanised	10	M30	50,9	24	46	DIN 934
B0101.333	steel	galvanised	10	M33	55,4	26	50	DIN 934
B0101.336	steel	galvanised	10	M36	60,8	29	55	DIN 934
B0101.506	steel	bright (black)	12	M6	11,05	5	10	DIN 934
B0101.508	steel	bright (black)	12	M8	14,38	6,5	13	DIN 934
B0101.510	steel	bright (black)	12	M10	18,9	8	17	DIN 934
B0101.512	steel	bright (black)	12	M12	21,1	10	19	DIN 934
B0101.516	steel	bright (black)	12	M16	26,76	13	24	DIN 934
B0101.520	steel	bright (black)	12	M20	32,95	16	30	DIN 934
B0101.524	steel	bright (black)	12	M24	39,6	19	36	DIN 934

Hexagon nuts DIN 934, steel

Overview of items

Order No.	Material	Surface finish body	Grade	D	E	H	SW	DIN
B0101.527	steel	bright (black)	12	M27	45,2	22	41	DIN 934
B0101.530	steel	bright (black)	12	M30	50,9	24	46	DIN 934
B0101.536	steel	bright (black)	12	M36	60,8	29	55	DIN 934